



31 Fitzroy Street Kilmore, VIC



A half-acre vintage gem

Wilson Partners is proud to present 31 Fitzroy Street, Kilmore.

Welcome to a timeless masterpiece of Federation style architecture. This enchanting home with a rich history spanning 115 years, has been meticulously renovated to seamlessly blend its vintage charm with modern comforts. As you step inside, you will be greeted by high ceilings and timber flooring throughout.

Grand hallways lead you gracefully through to the formal lounge and dining room, complete with split system, original fireplace and ample sitting space including a ledge seat underneath the window.

The master bedroom has been carefully tailored offering ample built in robe space and a private ensuite. The remaining guest bedrooms are generous in size and each adorned with open fireplaces and one featuring double aspect windows allowing for plenty of natural light.

Georgina Smith

0490 663 721

www.wilsonpartners.com.au

Land Size
2000m²
Approx

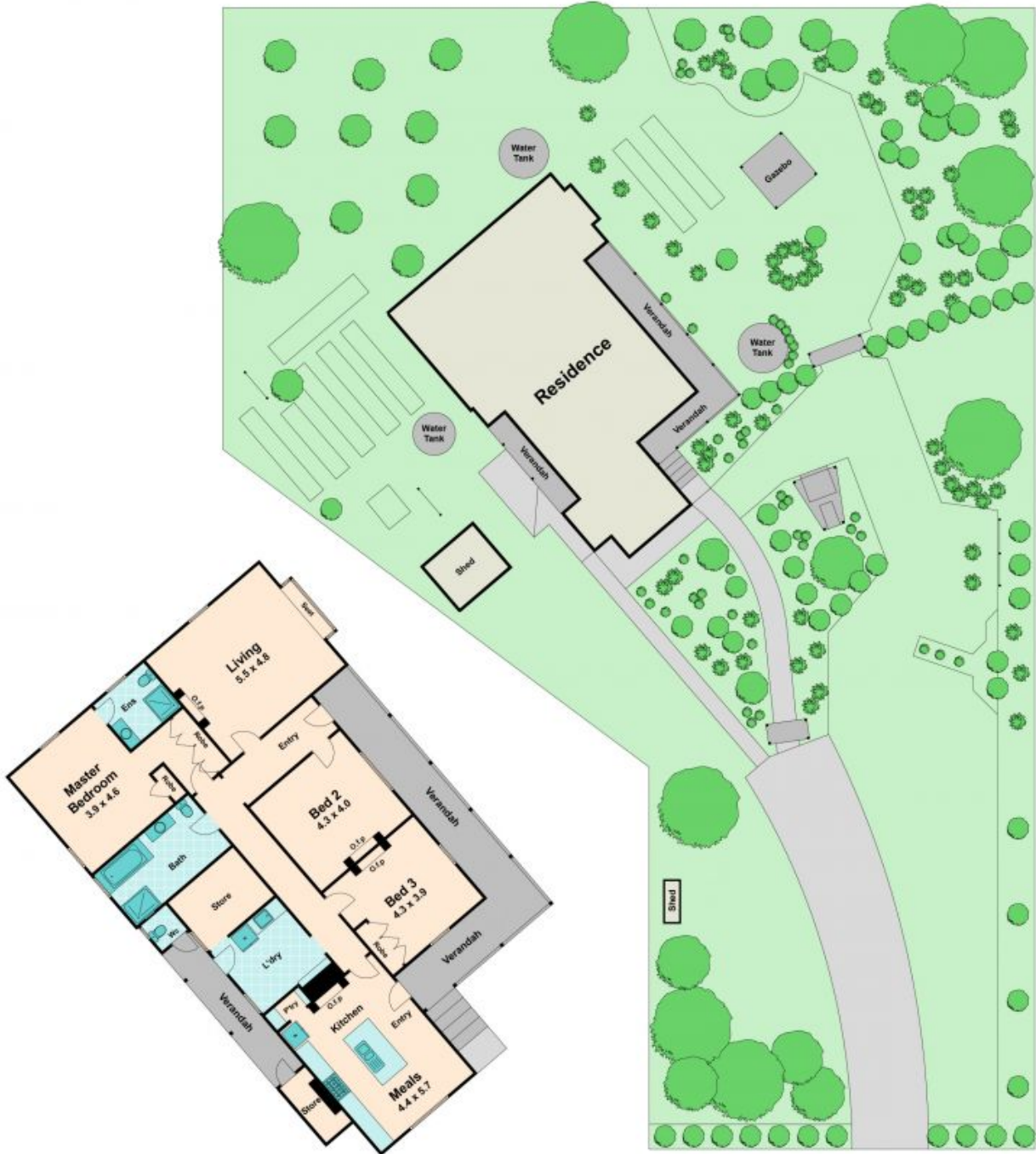

31 Fitzroy Street

Kilmore, VIC