



50 Powlett Street KILMORE, VIC



## Spacious home on large allotment

Wilson Partners is proud to present 50 Powlett Street, Kilmore.

The property is situated on the main street of town providing easy access to local shops, cafes, schools and other amenities. Kilmore is a charming and friendly town that offers a great community atmosphere and is the ideal suburb to raise a family.

Inside you will find 5 spacious bedrooms, a formal living and an extra theatre room for movie nights or catching up on your favourite TV shows.

The property boasts a spacious and well maintained back yard on 1011m<sup>2</sup>, perfect for outdoor entertainment or room for that shed you've always wanted.

One of the standout features of this property is the large pergola that offers an undercov

**Georgina Smith**

0490 663 721

[www.wilsonpartners.com.au](http://www.wilsonpartners.com.au)

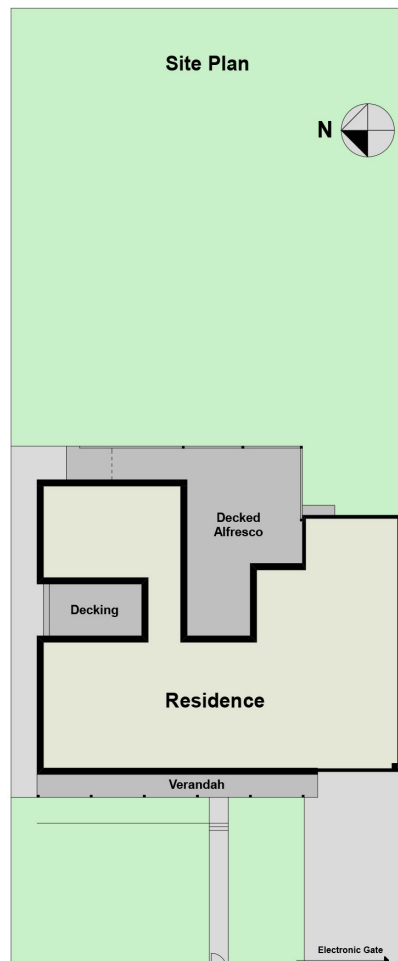

50 Powlett Street

KILMORE, VIC