



WILSON PARTNERS



WILSON PARTNERS



WILSON PARTNERS



WILSON PARTNERS

3B Pinewood Place Kilmore, VIC



The Perfect Property

Wilson Partners is proud to present 3B Pinewood Place, Kilmore.

This home is just so pretty. Located in a quiet pocket in a desired location and privately placed on a corner block, it is ideal for first home buyers, downsizers or investors who are seeking a neat and sturdy rental that will bring steady return for years to come.

Not only has the home been further established, it has been well loved and looked after with low maintenance gardens, a recent lick of paint and offers a generous and functional layout.

Extended features of this home include double lock-up garage, rear roller door access, gar

Bianca Thomas

0425 733 651

www.wilsonpartners.com.au

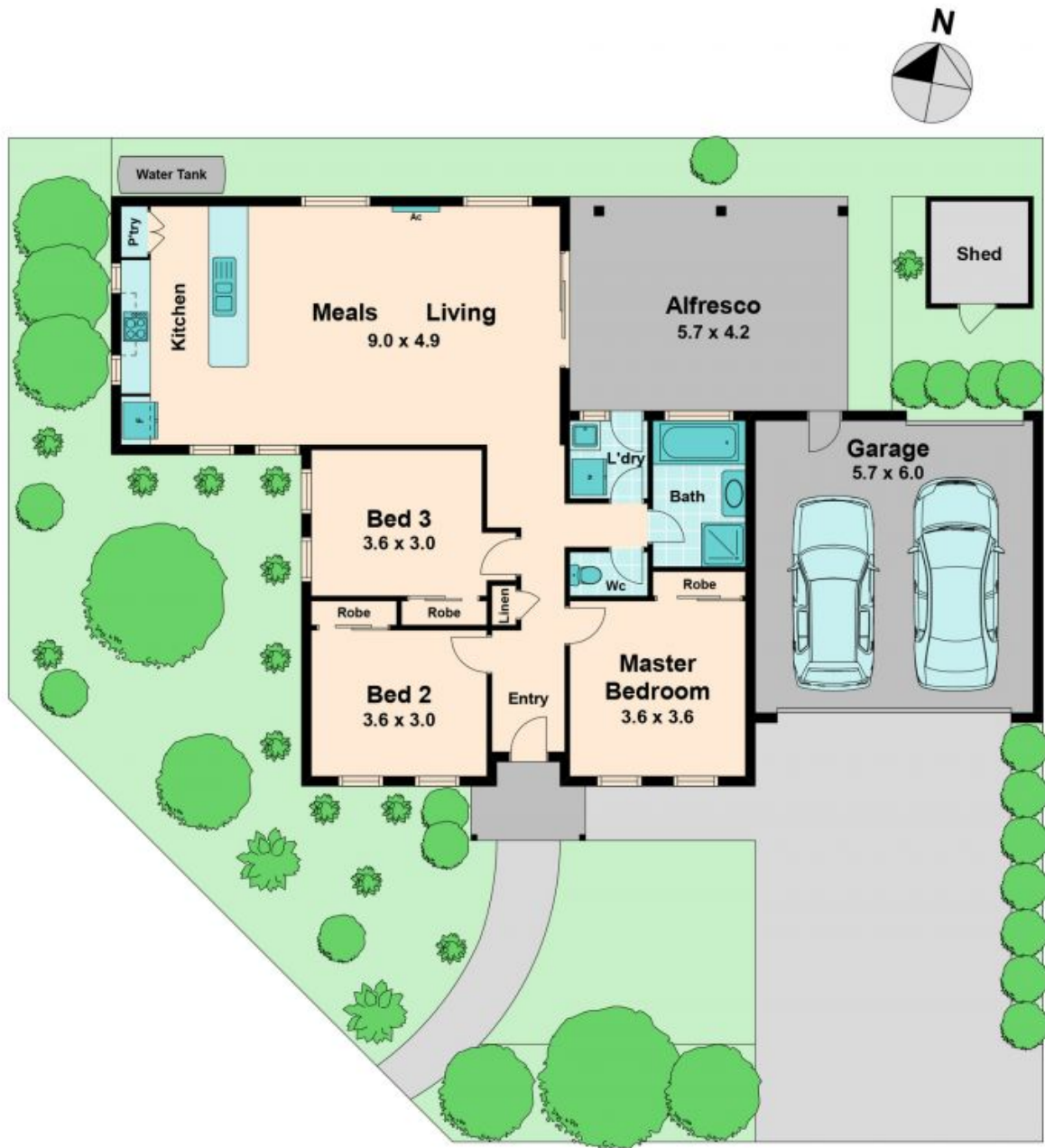

3B Pinewood Place

Kilmore, VIC