



WILSON PARTNERS



2/11-13 Sydney Street KILMORE, VIC

ONE STOP POP UP SHOP

Wilson Partners Kilmore is proud to present Shop 2/11-13 Sydney Street, Kilmore.

Have you been looking for an affordable, perfect start up commercial property?

Located in the well known HeyDay Arcade, this perfect little office space is ideal for a small business wanting a presence in the heart of town.

Accompanied by several other businesses in the complex and offering main street signage space - this is the beginning of locals learning your name!

Georgina Smith

0490 663 721

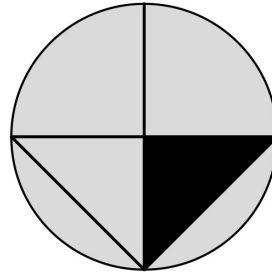

N

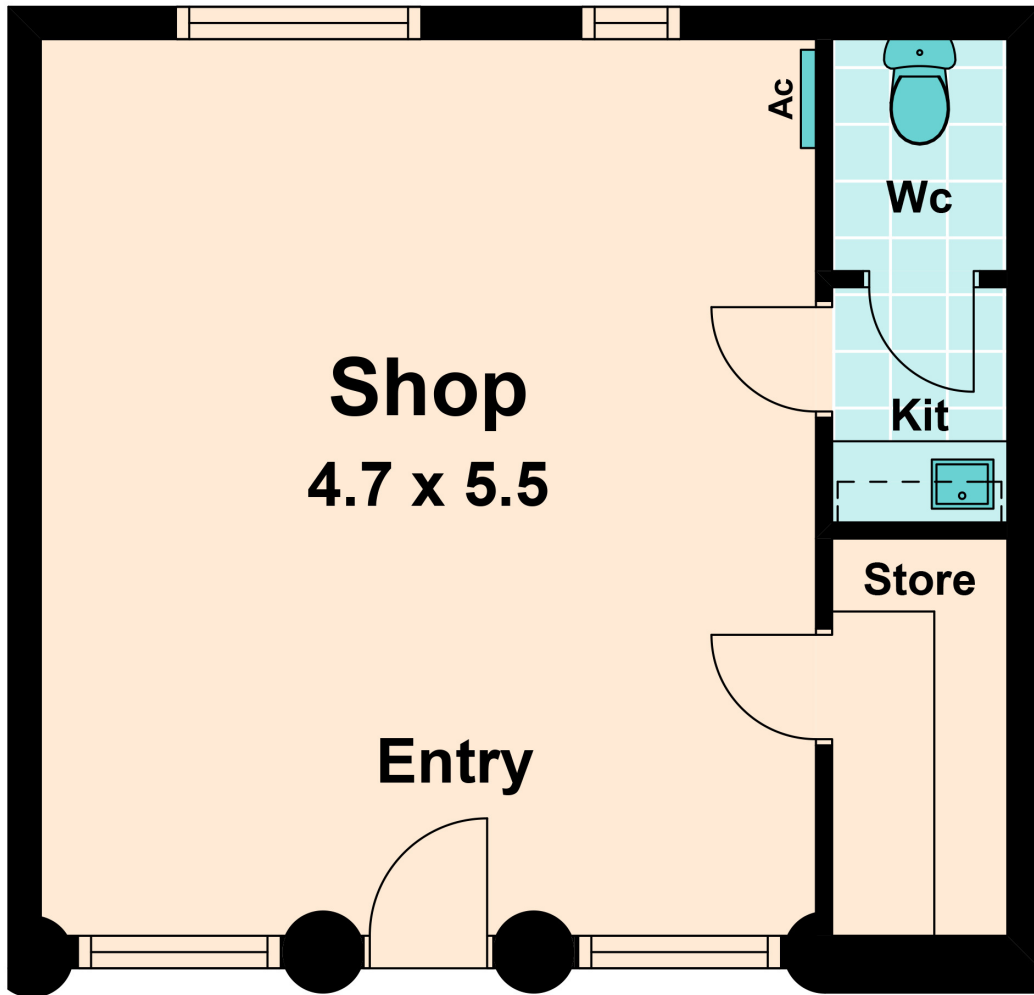

2/11-13 Sydney Street

KILMORE, VIC