



61-63 North Mountain Road HEATHCOTE
JUNCTION, VIC



Country Lifestyle at its best

Offering a serene family lifestyle, 61-63 North Mountain Road sits on a generous 3462m² providing ample space for the ultimate tree-change in the highly sought after Heathcote Junction.

This proud family home boasts an impressive floorplan with formal lounge area with spotted gum timber floors throughout and second central family area with a Coonara fireplace.

A recently updated kitchen is the heart and highlight of this home with a walk in pantry, plenty of cupboard storage and a well considered serving window for entertaining guests out on the verandah.

There has been no reservation on the expansive master suite, offering a walk in wardrobe with extra room for a study nook or parent's reading retreat and sliding door access to the verandah. Additionally, you are treated to a large renovated en-suite with modernized fix

Bianca L Thomas Property Management

+61 425 733 651

www.wilsonpartners.com.au

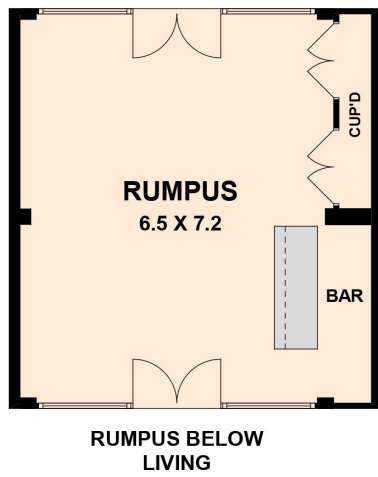
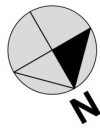
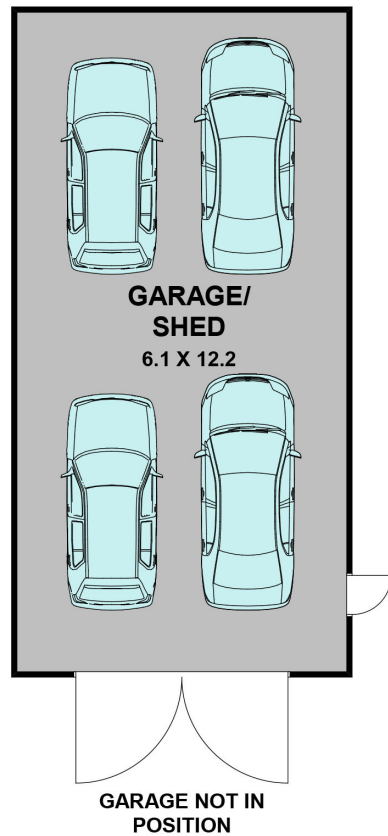

61-63 North Mountain Road

HEATHCOTE JUNCTION, VIC