



16 Vista Court HEATHCOTE JUNCTION, VIC



Acreage Lifestyle Without Compromise

Poised on a landscaped 4772 sqm (approx) allotment with serenity guaranteed, this sprawling ranch-style family residence is positioned in a tightly-held enclave in one of the Mitchell Shire's most sought after areas.

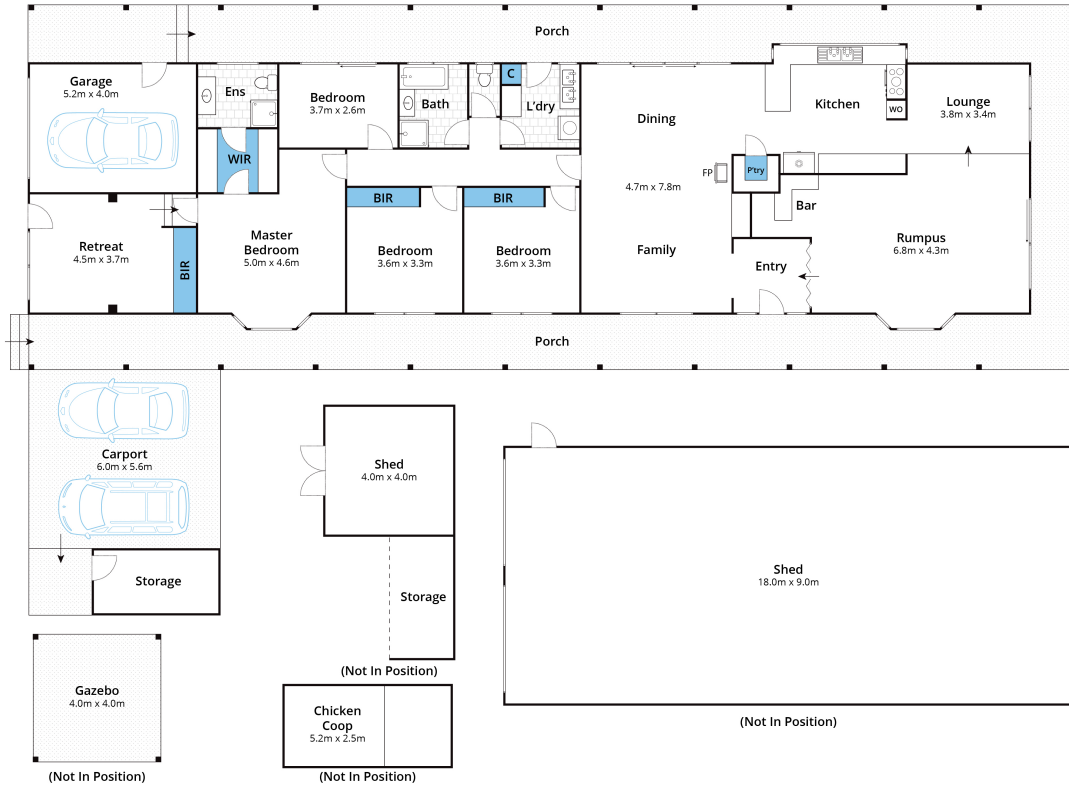

Whilst bwr.com.au has made every attempt to ensure the accuracy of the floor plan contained here, measurements are approximate and no responsibility is taken for any error, omission, or mis-statement. This plan is for illustrative purposes only.

16 Vista Court, Heathcote Junction