



8/35E George Street KILMORE, VIC



Low Maintenance Unit In Premier Location

Privately positioned to the rear of a boutique complex, this two-bedroom single level home is the perfect opportunity for those looking to start out in style, downsize without compromise or invest with success in a prime location close to local shopping, transport and amenities.

Located within walking distance of Kilmore main street shops and cafes, racecourse, primary and secondary schools, local parks and playgrounds, and just a short drive to Kilmore Train Station and the Hume Freeway.

Total Approx. Floor Area 111SQ.M

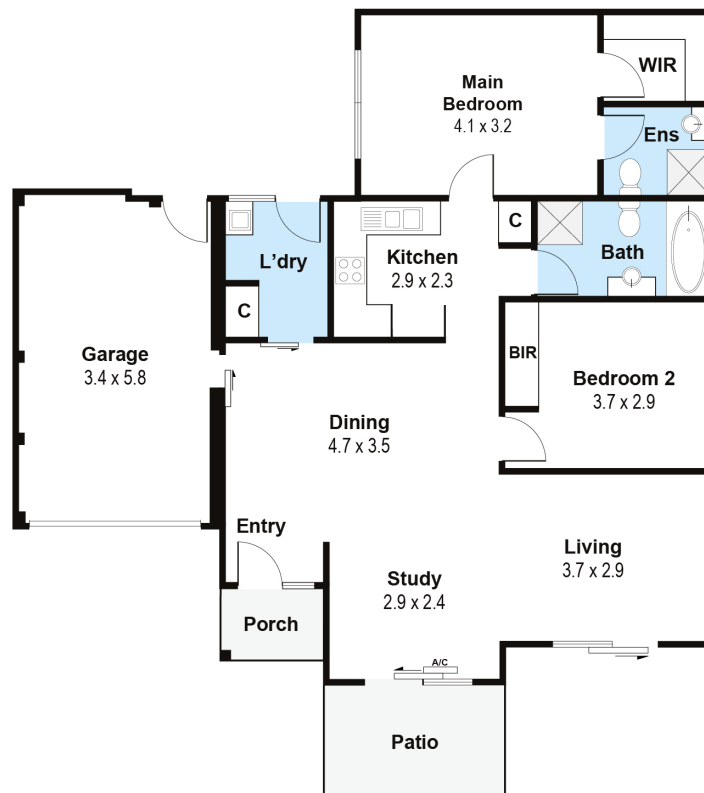
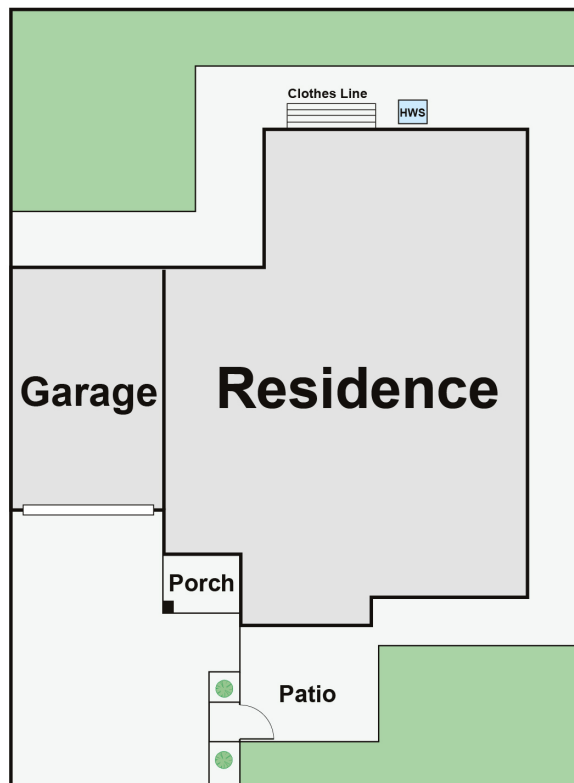

Unit 8/35E George Street, Kilmore 3764

Whilst every attempt has been made to ensure the accuracy of the floor plan contained here, measurements are approximate and no responsibility is taken for any error, omission or misstatement. This plan is for information purposes only and should not be used as such by any prospective purchaser.

8/35E George Street KILMORE, VIC