



1 Windsor Drive WALLAN, VIC



Marvellous family acreage in a prestigious Wallan pocket

This impressive home is placed just a stone's throw to Wellington Square shops, town centre cafes and restaurants, three supermarkets, Wallan Medical Centre, a selection of parks and playgrounds. In addition, it is located within close proximity to Wallan Primary School, Wallan Secondary College, childcare options, as well as local sporting clubs, V/Line trains and the Hume Freeway.

A circular driveway provides access to the charming brick facade and full width verandah, where the foyer flows into a magnificent formal lounge and dining area, light filled living area with an open fireplace, and informal dining zone. At the heart of the home is an immaculate timber kitchen with a dishwasher, breakfast bar and plentiful cabinetry. Step outdoors to a private entertaining area and huge backyard with plenty of room for kids, pets and extra vehicles. The well defined floorplan has a large master bedroom with built-in robe.

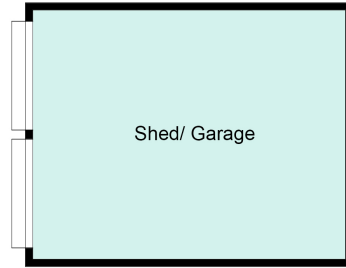
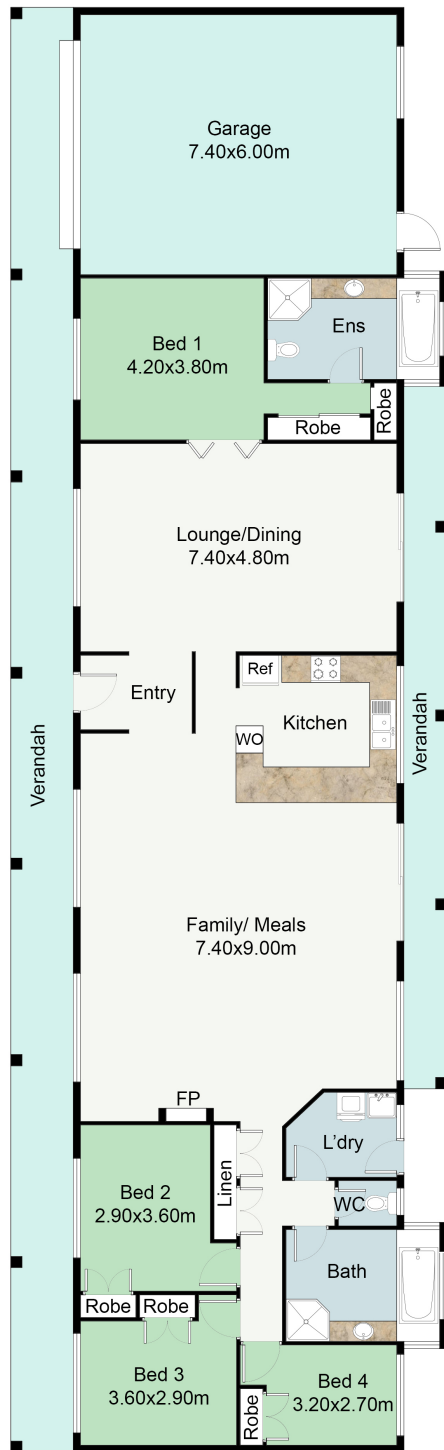

FLOOR PLAN

This floor plan including furniture, fixture measurements and dimensions are approximate and for illustrative purposes only. BoxBrownie.com gives no guarantee, warranty or representation as to the accuracy and layout. All enquiries must be directed to the agent, vendor or party representing this floor plan.

1 Windsor Drive, Wallan
1 Windsor Drive WALLAN, VIC