



7/32 Rutledge Street KILMORE, VIC



## Smart designer townhouse in the heart of Kilmore

Commanding a highly desirable address in Kilmore's leafy heart, opposite the esteemed Kilmore International School, this smart designer townhouse boasts a seamless fusion of space, style and relaxed comfort. Custom tailored for modern living, it presents a bright double storey layout dressed in premium appointments and north facing alfresco entertaining that backs onto a leafy reserve. Move straight in and take your place in a family-friendly community, or secure a solid investment with a proven return.

It reveals a large living room and light filled family and dining area at the back. A sliding glass door leads to the private entertaining patio and sunny low maintenance garden with access to the reserve. A sleek stone kitchen offers quality stainless steel appliances (including gas cooking and a dishwasher) and a breakfast bar. Upstairs is a central study zone, generous master bedroom with a walk-in robe and ensuite, two bedrooms with built-in

7/32 Rutledge Street, Kilmore, VIC. 3764

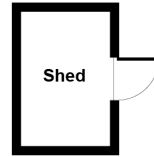

( Not In Position )



163 Sq mtrs



7/32 Rutledge Street

Whilst every care has been made in drawing this floor plan,  
it is for illustration purposes only and is not to scale.  
All details should be independently verified.

KILMORE, VIC