



38 Church Street KILMORE, VIC



CHARMING ON CHURCH!

Perfectly positioned on approximately 879m² and in one of Kilmore's tightly held locations this charming home is searching for its new owner. Situated close to shops, Kilmore Race Track, Tennis courts, Bowls Club, The Kilmore International School, Assumption College and many other local amenities this home is the perfect buy.

This charismatic home offers two well sized bedrooms, the main complete with a robe, a main bathroom with bath separate to shower and a private sunroom perfect to enjoy your morning cupper.

The exterior of the property offers a one bedroom bungalow which could be the perfect teenager's or grandparents retreat.

Contact Bianca Thomas today before this property gets snapped up!

Bianca L Thomas

+61 425 733 651

www.wilsonpartners.com.au

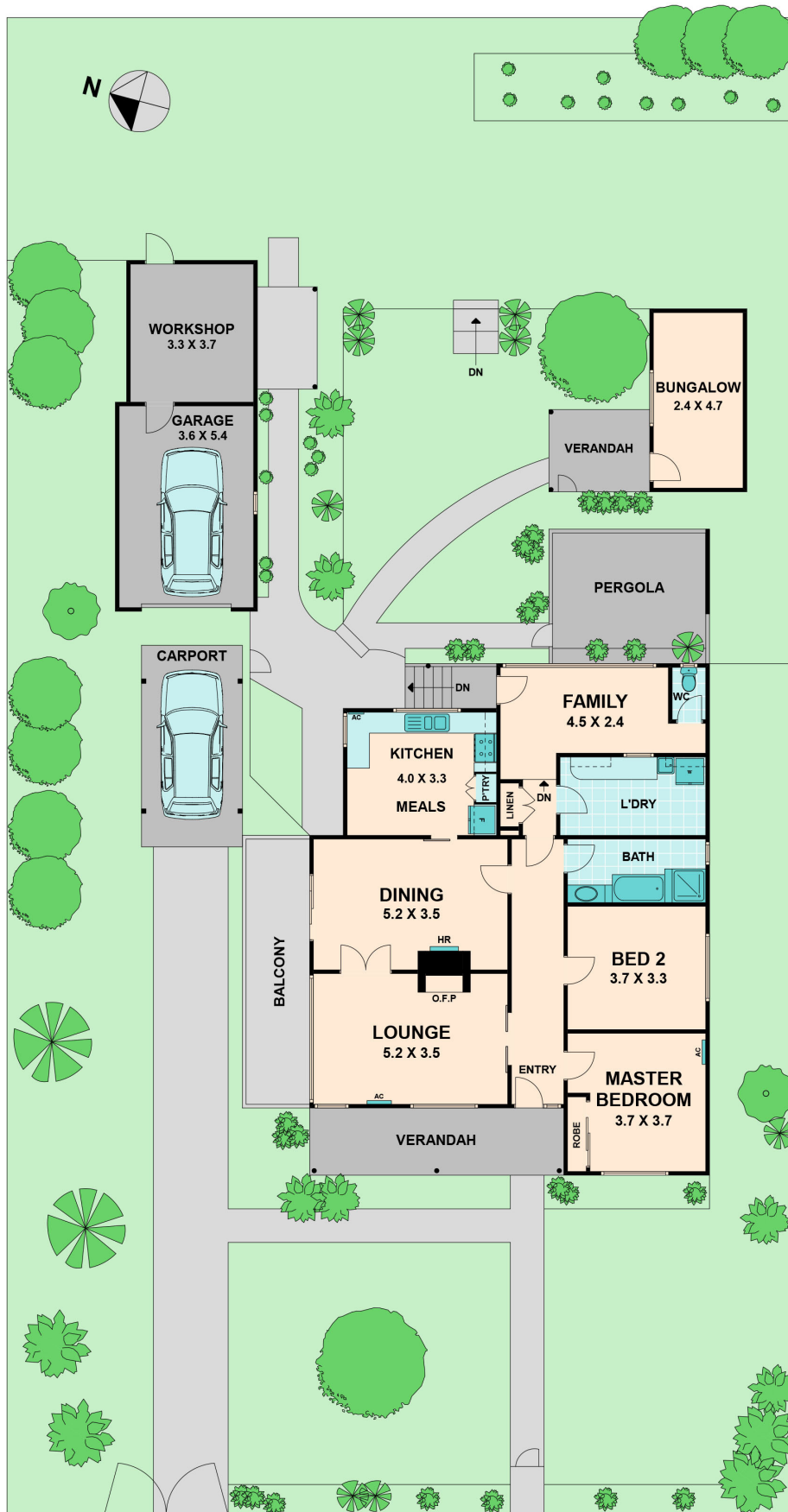

38 Church Street

KILMORE, VIC