



26 Station Avenue WANDONG, VIC



The Birchs ? a landmark family home in a coveted country locale

Commanding 1,885sqm in the picturesque heart of Heathcote Junction, ?The Birchs' is a landmark family residence that captures the essence of classic country living. Framed by stunning established trees, it presents a spacious double storey design with elegant modern interiors that flow to impressive north facing alfresco entertaining. This is a rare opportunity to secure your dream lifestyle in a coveted up-and-coming pocket of Melbourne's northern growth corridor.

Fully fenced with an electric gate, a concrete circular driveway leads to the gracious weatherboard facade with a charming verandah. The leadlight entrance reveals a generous living room with a gas fireplace, light filled nearby dining area and immaculate timber kitchen with quality stainless steel appliances including a Miele dishwasher. Step outdoors to a magnificent undercover entertaining area with a wood burning fireplace and integrated barb

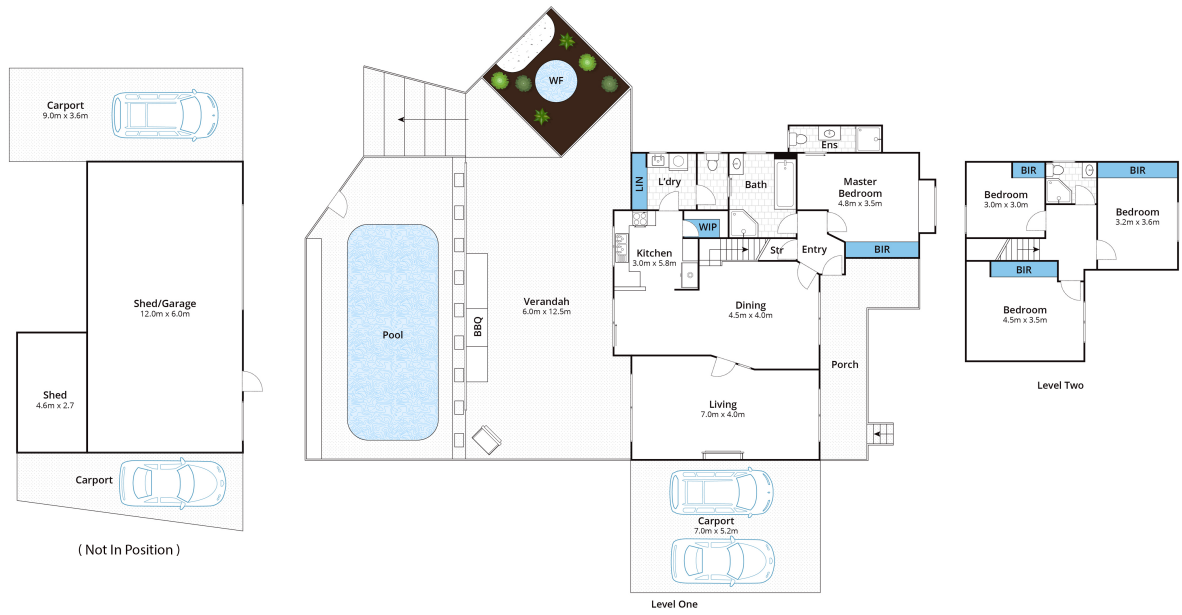

Whilst bwr.com.au has made every attempt to ensure the accuracy of the floor plan contained here, measurements are approximate and no responsibility is taken for any error, omission, or mis-statement. This plan is for illustrative purposes only.

26 Station Avenue, Heathcote Junction

26 Station Avenue

WANDONG, VIC