



45 DONALDSON DRIVE BROADFORD, VIC



Welcome to your new family home!

Situated in one of Broadford's most sought after locations is this impressive home sitting on a generous block of approximately 980m².

From the moment you walk through the door be instantly swept away with this grand entrance, that boasts a sense of spaciousness.

The home offers four generous sized bedrooms, all with built in robes, and the master is completed with a largely accessible ensuite.

The open kitchen/dining/lounge area has room for the entire family and includes an expansive walk in pantry, ample counter and cabinet space.

The exterior of the property offers a double garage with rear car access, a spacious decked undercover entertainment area, shed/workshop with concrete floor and power and side access to yard.

If you're ready to have a look at this impressive home contact Bianca Thomas today to book a private inspection.

Bianca L Thomas

+61 425 733 651

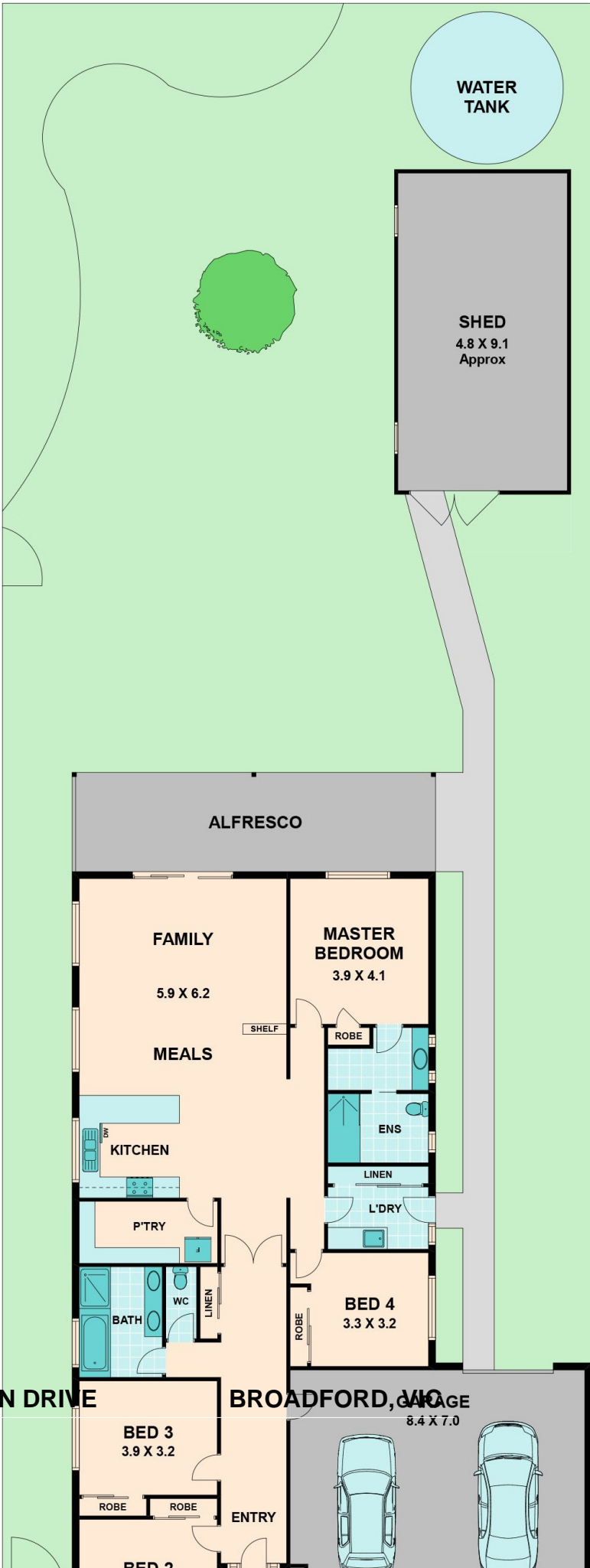
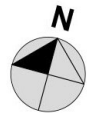

45 DONALDSON DRIVE

BROADFORD, VIC

BED 3
3.9 X 3.2

GARAGE
8.4 X 7.0

BED 2

FAMILY
5.9 X 6.2
MEALS

MASTER BEDROOM
3.9 X 4.1

KITCHEN

P'TRY

BATH

WC

ROBE

ROBE

ENTRY

ROBE

ENS

LINEN

L'DRY

ROBE

BED 4
3.3 X 3.2

WATER TANK

SHED
4.8 X 9.1
Approx

ALFRESCO

SHELF