



30 Carmelo Court HIDDEN VALLEY, VIC



Magnificent designer family home in the coveted Hidden Valley Estate

Commanding 1,100sqm in a coveted pocket of Hidden Valley Estate, this magnificent designer home captures the essence of contemporary family living with a tranquil country backdrop. Custom tailored with high quality fixtures and finishes, the sumptuous free flowing layout is complemented by child-friendly alfresco entertaining with a glorious north aspect.

The foyer leads to a superb living room and spacious open plan family and dining area bathed in natural light at the back. Dressed in sleek stone benchtops, the stunning gourmet kitchen boasts premium stainless steel gas appliances, a walk-in pantry and an island bench with a breakfast bar. Sliding glass doors afford dual access to the huge covered wraparound deck, ideal for year-round entertaining with retractable blinds and sweeping district views, and an expansive sun soaked backyard framed by stunning manicured gardens. It also has a plush master bedroom with a walk-in robe and twin ensuite, two generous bedrooms with built-in robes and sparkling family bathroom offering a bath, shower and separate w/c. It

www.wilsonpartners.com.au

Total Approx. Floor Area 175sqm

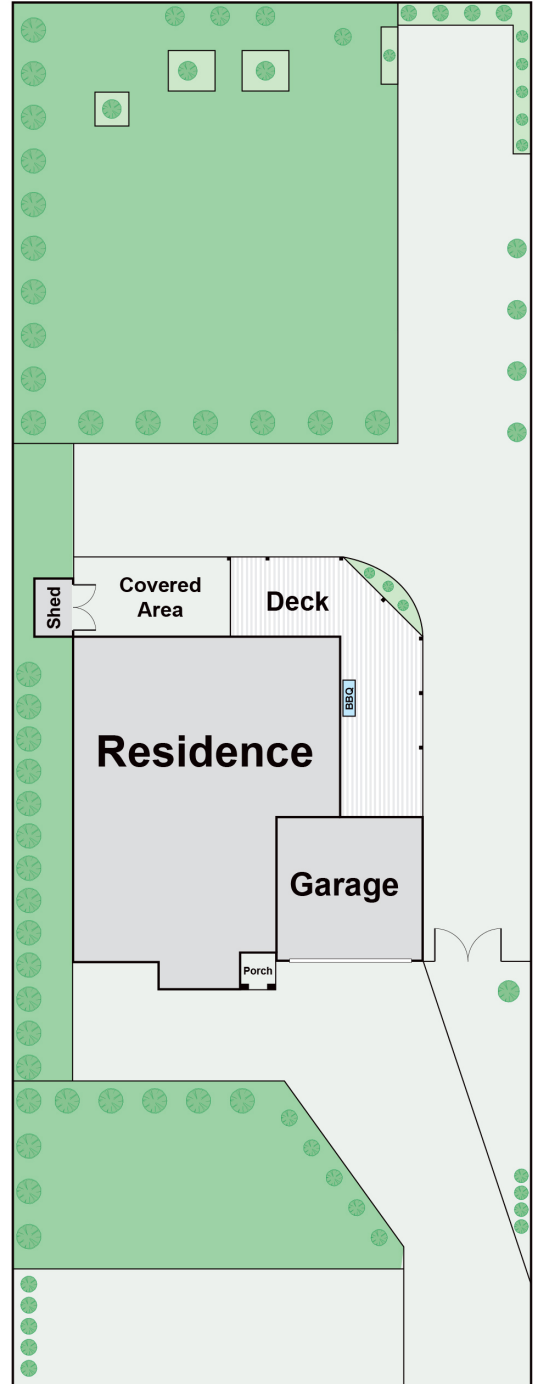
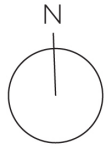
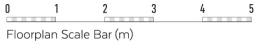

30 Carmelo Court, Hidden Valley VIC 3756

Whilst every attempt has been made to ensure the accuracy of the floor plan contained here, measurements are approximate and no responsibility is taken for any error, omission or misstatement. This plan is for illustrative purposes only and should not be used as such by any prospective purchaser.

30 Carmelo Court **HIDDEN VALLEY, VIC**

Wilson Partners