

25 POWLETT STREET KILMORE, VIC



KILMORE DEVELOPMENT OPPORTUNITY

This circa 1850's Church calls to that one true faithful ready to create your own heavenly home.

Sitting on an enormous 'L' shaped allotment of approximately 1500m2 and residential zone, this historical Uniting Church building has not only a main street frontage but also rear access via Piper Street. Located within walking distance to all local schools including Assumption College, St Patrick's Primary School and The Kilmore International School whilst only being a short walk to all of Kilmore's amenities.

Bianca L Thomas Alan Wilson

+61 425 733 651

0417 577 988

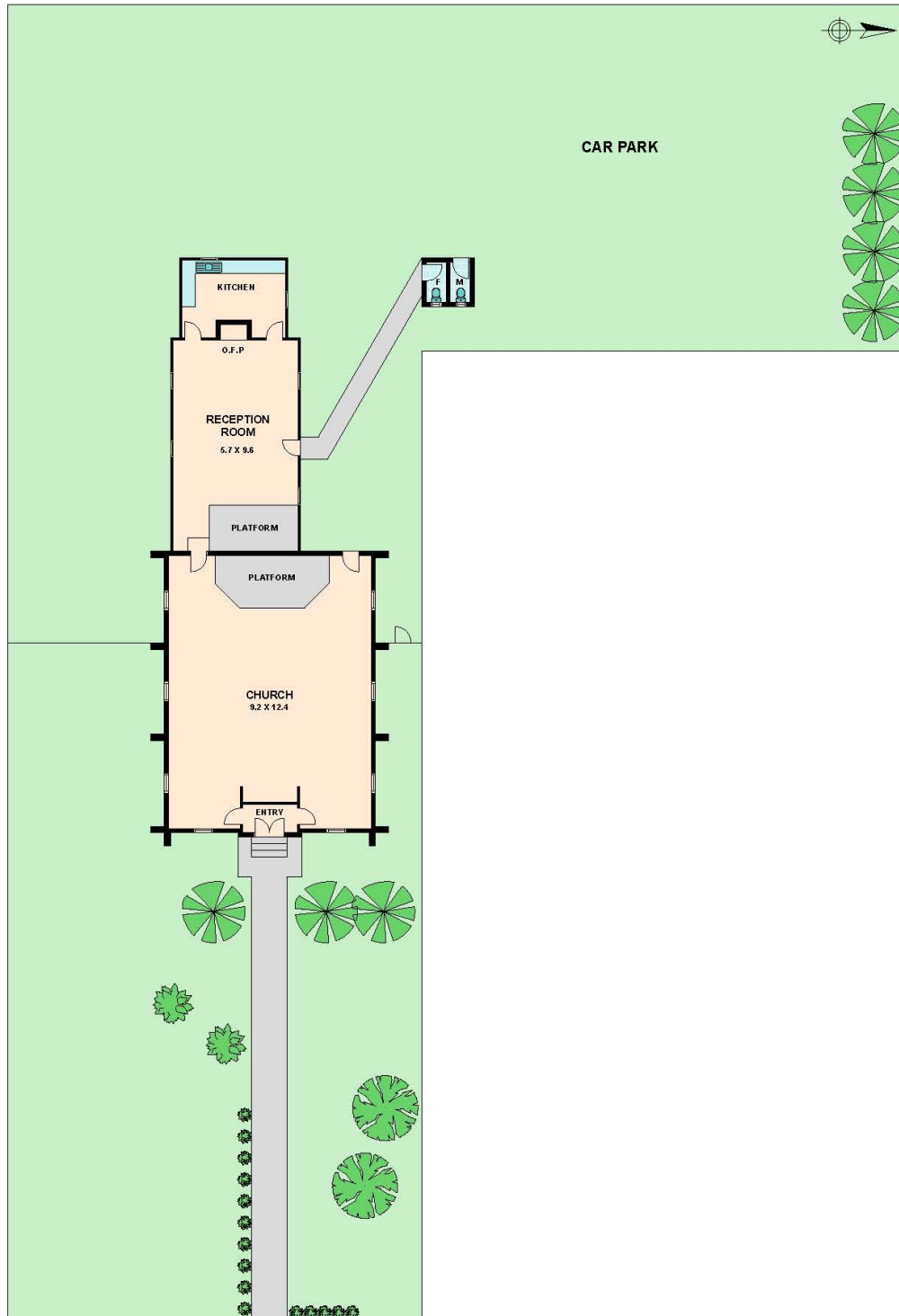

25 POWLETT STREET

KILMORE, VIC