



280 JEFFREYS LANE BROADFORD, VIC



## BROADFORD HOUSE ON ACREAGE FOR SALE

'Green Hazel Acres'

One of the finer properties in Broadford, this unique four bedroom abode combines both country home life, coupled with spectacular prosperous land.

Upon entering the home, there is a welcoming formal entrance featuring timeless black and white tiling, deep cedar coloured floor boards leading to the 1st of two living rooms inundated by glowing cream painted walls. A large bay window in the formal living room means the room stays light throughout the day, capturing the magnificent views of your private lake with charming jetty. On the other side of this grandiose living area you will find both the internal access to your personal two car garage, large double window with views to your outdoor entertaining terrace and entrance to your classic entertainer's kitchen. Your new kitchen feature endless cupboard space along with a buffet style that completes the ser

**Alan Wilson**

0417 577 988

[www.wilsonpartners.com.au](http://www.wilsonpartners.com.au)

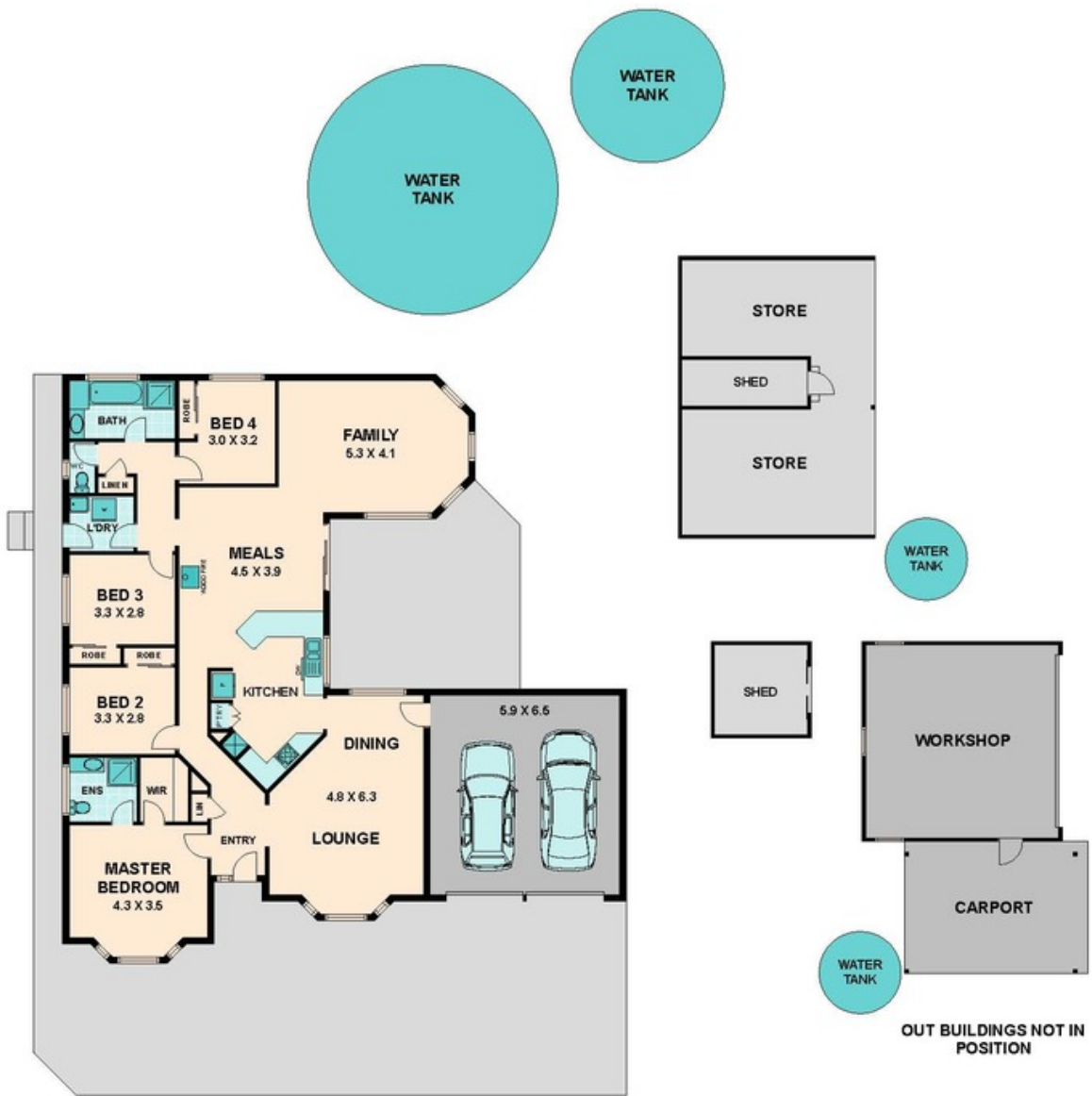

280 JEFFREYS LANE

BROADFORD, VIC