



1551 NORTHERN HIGHWAY KILMORE, VIC



KILMORE HOUSE ON ACREAGE

1551 Northern Highway is an exceptional property established within the Township of Kilmore, boasting outstanding historical credentials. The farm is recognised as one of the prestigious established properties in the region and has been continually sought after for its subdivision potential (STAC) and prime location.

The modern conveniences have not been forgotten with a large spacious kitchen with fully functional appliances, lime washed Tasmanian Oak timber cabinetry and the latest fully ducted heating system, not to forget the cool and refreshing split system air conditioning.

This remarkable property benefits from a number of other buildings and facilities including a self-contained 1 bedroom, 1 bathroom guest room under roof. Stable block with 3 stables, tack room and powered wash bay with both hot and cold water for complete equine comfort

Alan Wilson

0417 577 988

www.wilsonpartners.com.au

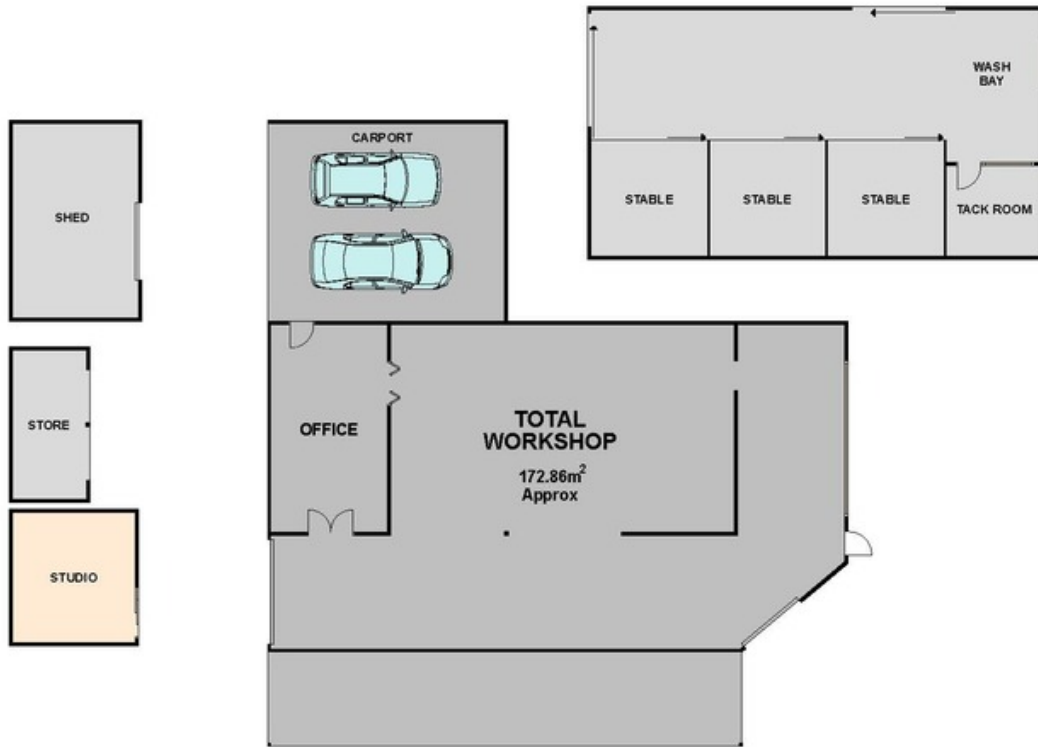

OUT BUILDINGS NOT IN POSITION



1551 NORTHERN HIGHWAY

KILMORE, VIC