



344 SAUNDERS ROAD KILMORE EAST, VIC



KILMORE HOUSE FOR SALE

Spectacular views and wow, you can see forever from this beautiful property of around forty five acres of undulating pastures, well fenced into multiple paddocks, selectively treed supporting natural shelters, keeping native and introduced animals very happy. A true sanctuary for humans as well, lovely areas for trail riding, nature walks and enjoying the tranquil surrounds with breath-taking sunsets and very beautiful sunrises. Just above the house is the perfect spot to sit and enjoy the 360 degree views, looking out towards Mt Piper to the North, the Great Dividing Range to the East, the Macedon Ranges to the West and glimpses of the lovely city lights to the South. With an estimated travel time of sixty minutes from Melbourne this lifestyle property must be seen to be appreciated. Surrounding an internal atrium the impressive six bedroom residence can easily cater to the largest of families, with a large walk in pantry and very well-appointed kitchen, meals area and large family room. A separate formal lounge plus a very generous rumpus provides loads of living. Completing this lovely property are two secure sheds plus two open bays with extra shedding for vehicles, machinery or storage. There is also a very large secure area that could be used for chickens, dogs, a pony, or pet goats and if this doesn't suit you it would be

www.wilsonpartners.com.au

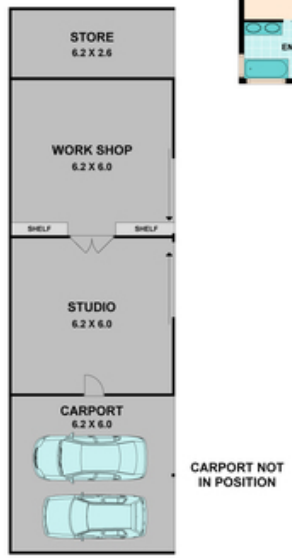
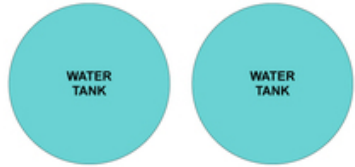

344 SAUNDERS ROAD

KILMORE EAST, VIC