



117 RAIL STREET HEATHCOTE JUNCTION, VIC



HEATHCOTE JUNCTION HOUSE FOR SALE

What a charming property! Just love it!! Large allotment approximately 3/4 of an acre . Drive through pretty gardens and behold the rustic charm and beauty of this classic western red cedar style country home. From the moment you enter the front door you will feel the warmth and character exuding from the beautiful finish of both the solid timber floors and ceiling. The expansive open lounge room flows to the large meals/dining area and is big enough to incorporate an office/study area. You wont be chilly though, thanks to the large combustion heater and additional gas and electric zone heaters. Check out the kitchen! Modern with large stainless steel oven and cook top, dishwasher, plenty of cupboard space and a very convenient 'roll out' pantry. The bedrooms are of a good size and all have built-in robes. Both bathroom and laundry are so spacious and different...very cool! Outside privacy fencing divides the backyard into several clusters of quiet, secluded sanctuary areas yet leaves plenty of space at the rear for the veggie garden or more. Is it a four car garage or will you use it as a 'man cave' or as a workshop? Whatever, it has power and concrete flooring. There is also plenty of water for those beautiful gardens from the 32,000 litre approx. fresh water tank. Oh! Don't forget about the power. This home comes with a huge

Bianca Thomas

0425 733 651

www.wilsonpartners.com.au

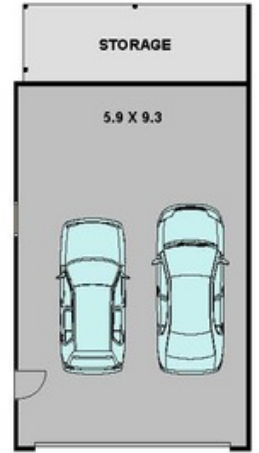
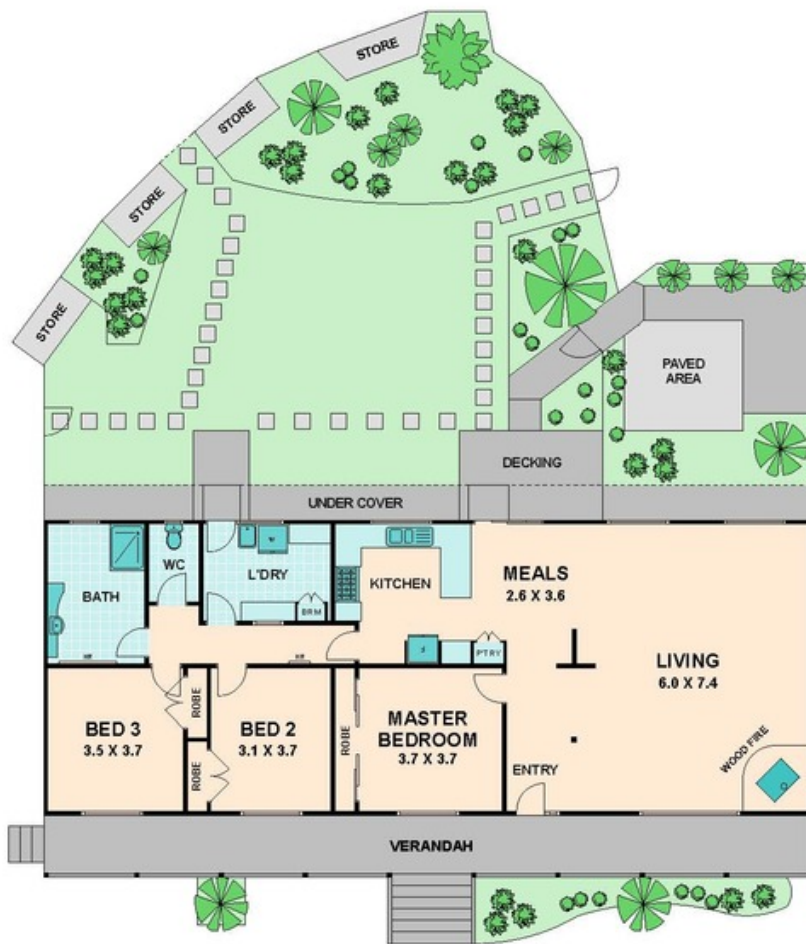

GARAGE NOT IN POSITION

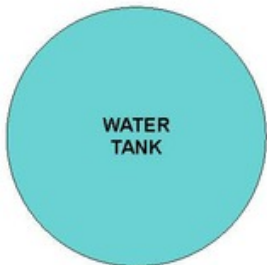

117 RAIL STREET

HEATHCOTE JUNCTION, VIC