



42 McDONALD DRIVE WANDONG, VIC



'GRAND LIVING'

Situated in the ideal position, on approximately 1.25 acres, to take advantage of sweeping views across the valley this splendid 40 square (approx.) home will captivate you on your first visit. Upon entry you can feel the expansive nature of the large formal lounge room flowing to a second massive family/dining off the modern well-appointed kitchen. Each of these big open plan areas are flanked by large glass windows and doors that lead to the outdoor elevated decking and entertainment area overlooking beautiful gardens of colourful scented flowers and blossoms. The master bedroom is large and accommodates a walk-in robe and full ensuite. The other two bedrooms are also a good size with built-in robes. In addition you can retreat to the dedicated theatre/games room or lock yourself away in the full size office/study at the other end. This lovely dwelling is so well insulated and includes a large 2.5kw (approximately) solar electric system, beautiful fan forced combustion heater, in floor heating, central vacuum system and much, much more. Everything in this stylish executive home screams quality and lifestyle! If that??s not enough the pretty two bedroom bungalow is self-sufficient with a summer kitchen, lounge room and reverse cycle air conditioning. Ideal for those large family gatherings. Extremely well priced to sell quick!

Bianca Thomas

0425 733 651

www.wilsonpartners.com.au

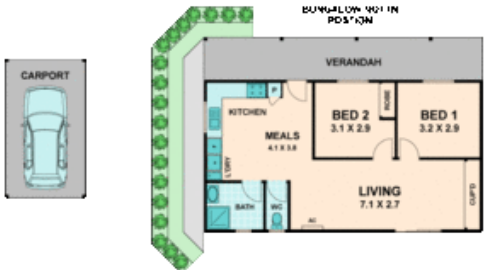

42 McDONALD DRIVE

WANDONG, VIC