

3 LAMB STREET KILMORE, VIC



IS IT...A FASHAM JOHNSON?

We sure think so but can't say for sure. It smacks of everything Fasham Johnson.

The tell tale Skillian roof and innovative use of captured light through domed skylight is classic architecture of the 70's.

Inspect with a view to creating your dream and renovate.

This superbly designed 3 bedroom, solid Bessa Brick will blow your minds with it's potential.

Double carport and a double galvanised garage on a huge allotment. Only a short walk to town, The Kilmore International School, Assumption College or either of the two primary schools.

No doubt this one needs some T.L.C. but imagine the possibilities.

Inspect today as the Vendor invites all offers.

Alan Wilson

0417 577 988

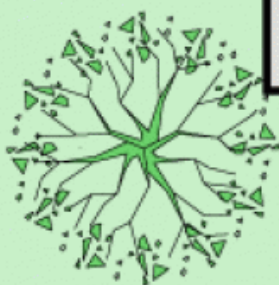

SHED

5.0 X 7.0
Approx

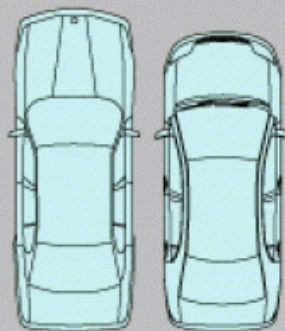

3 LAMB STREET

KILMORE, VIC

BED 3
3.5 X 2.4

BED 2
3.4 X 3.4

BATH

ROBE

ROBE

MASTER
BEDROOM
3.4 X 3.5

L'DRY

BR